

0 1.5 3 6 Miles

**Monroe Lake**  
**Township Road 1001 (Main Cross Street)**  
**Malaga Township, Ohio 43793; Monroe County**

**Sources:**  
**Non Orthophotography Data:** U.S. Census  
 Ohio County Map  
**Orthophotography:** ESRI World Street Map  
**Map Projection:** UTM Zone 17 N **Map Datum:** NAD83

## Project Location Map

PLOTTED: 4/23/2020 11:23:31 AM

P:\PR57701\Cadd\Sheets\MONROE LAKE PROPOSED PLAN.dwg 4/23/2020 10:14:23 AM VanZandt, Ryan

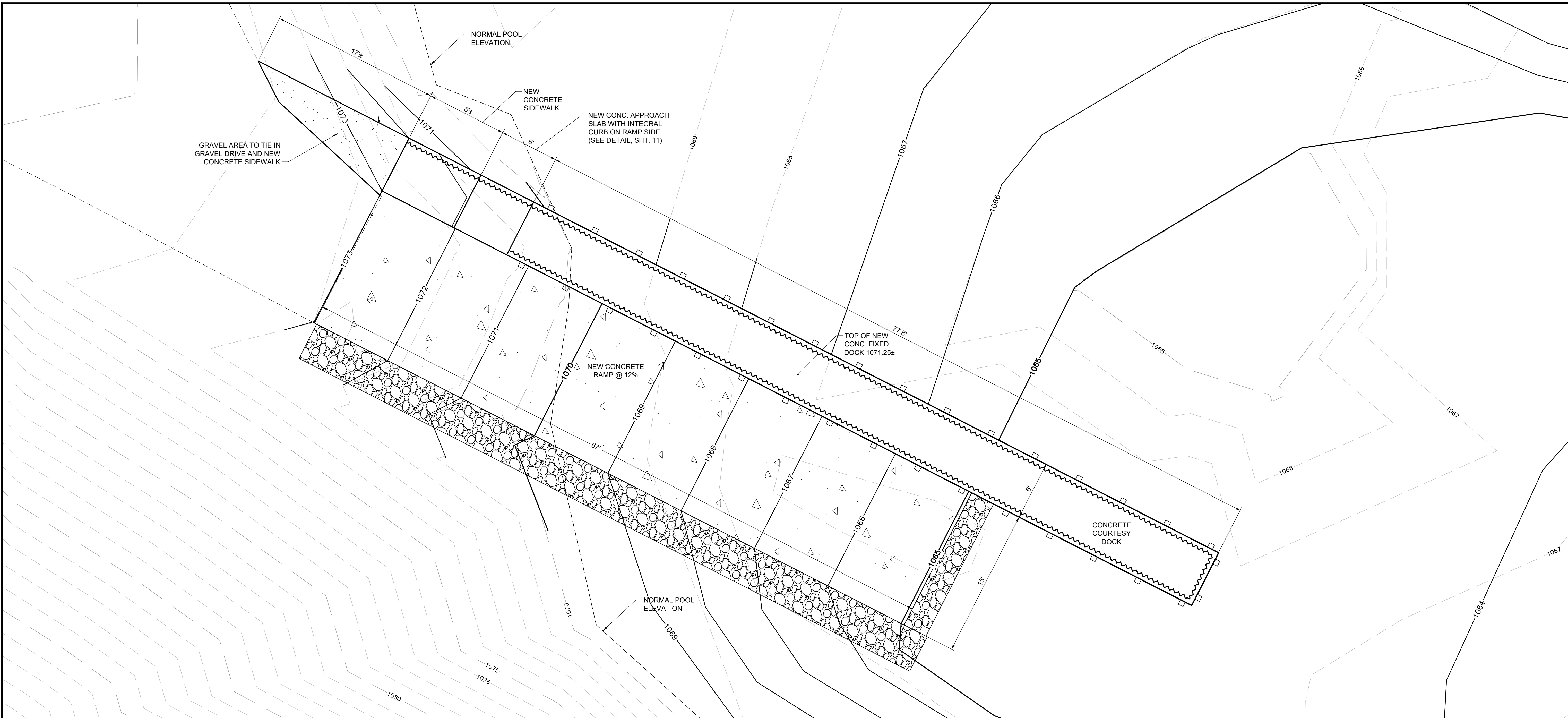

**PROPOSED SITE PLAN**

SCALE: 0 5' 10'

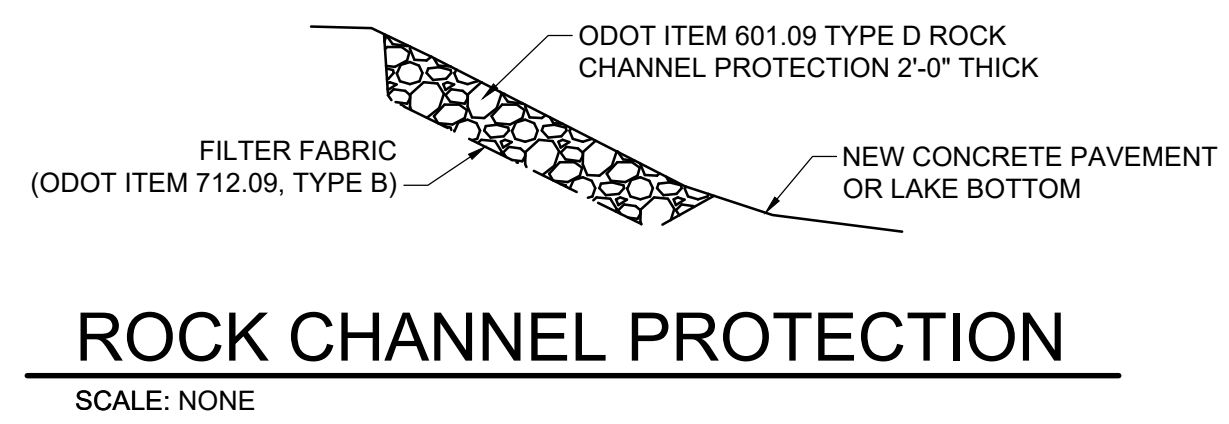

**CODED NOTES:**

1. THE DOCK EDGES SHALL BE CONSTRUCTED IN A STRAIGHT LINE IN ALIGNMENT WITH THE EDGE OF THE CHANNEL. NON-LINEAR TOP OF SHEET PILING ALONG DOCK ALIGNMENT SHALL BE COMPENSATED BY CONTRACTOR TO PROVIDE STRAIGHT EDGES FOR CONCRETE DOCK/RAMP.

**GENERAL NOTES:**

VERTICAL CONTROL. ELEVATIONS SHOWN ARE BASED ON A SITE SURVEY BY RESOURCE INTERNATIONAL, INC. ON APRIL 1, 2020. ELEVATION ARE NORTH AMERICAN VERTICAL DATUM OF 1988. SEE SHEET 03 FOR SITE BENCHMARKS AND CONTROL POINTS.

HORIZONTAL CONTROL. HORIZONTAL CONTROL IS BASED ON OHIO STATE PLANE COORDINATE SYSTEM (SOUTH ZONE) AND THE LOCATION OF EXISTING STRUCTURES.

EXISTING UTILITIES AND STRUCTURES. THE LOCATION OF UTILITIES AND STRUCTURES SHOWN ON THE PLANS IS FROM INFORMATION OBTAINED FROM A SITE SURVEY. THE LOCATION OF UTILITIES AND STRUCTURES INDICATED IS NOT NECESSARILY COMPLETE OR CORRECT. THE LOCATION, SUPPORT, PROTECTION, AND RESTORATION OF ALL UTILITIES, SERVICES, STRUCTURES, & APPURTENANCES ARE THE RESPONSIBILITY OF THE CONTRACTOR.

UTILITY COMPANY NOTIFICATION. CONTRACTOR SHALL NOTIFY ALL UTILITY COMPANIES AT LEAST 2 WORKING DAYS PRIOR TO WORK IN THE VICINITY OF THEIR UNDERGROUND AND/OR OVERHEAD LINES. CONTACT OHIO UTILITIES PROTECTION SERVICE, 1-800-362-2764. NONMEMBER UTILITIES MUST BE CONTACTED.

SEEDING. ALL AREAS DISTURBED OR DAMAGED BY THESE CONSTRUCTION ACTIVITIES, WHICH ARE NOT OTHERWISE NOTED TO BE COVERED WITH GRAVEL OR PAVEMENT SHALL BE FINISH GRADED AND SEEDED. GRADING SHALL BE PROVIDED TO ENSURE POSITIVE SITE DRAINAGE AWAY FROM STRUCTURES, BUILDINGS, AND DRIVEWAYS AND BE SUCH THAT THERE WILL BE NO PONDING OR STANDING WATER FOLLOWING PRECIPITATION EVENTS. SEEDING AND MULCHING SHALL BE IN ACCORDANCE WITH ODOT ITEM 659, CLASS 1 SEED MIX FOR LAWNS.

MONROE LAKE WATER LEVELS. CONTRACTOR SHALL BE AWARE THAT A NORMAL POOL ELEVATION OF APPROXIMATELY 107X.X±±. THE LAKE WATER LEVELS ARE PLANNED TO BE REDUCED TO BELOW ELEVATION 107X± DURING CONSTRUCTION. THE CONTRACTOR SHALL COORDINATE THEIR SCHEDULE WITH ODNR, NOTIFYING THEM A MINIMUM OF 6 WEEKS PRIOR TO WHEN THE CONTRACTOR WILL BE COMMENCING WORK ON THE RAMP.

SOIL BORINGS TAKEN ON XXXX BY RESOURCE INTERNATIONAL, INC. BORING LOGS AND SOILS INFORMATION INCLUDED AS APPENDIX TO PROJECT SPECIFICATIONS.